

Subplot area table for Dholera-345, FP-148

Subplot number	Dimensions (Mt)	Subplot area (Sqmt)	SBU area (Sqmt)	Subplot area (sqyd)	SBU area (Sqyd)
1	26.00 X 54.58 = 308.02 Lees curve = 17.41	1401.67	2030.48	1676.40	2428.46
2	24.50 X 54.58	1337.21	1937.10	1599.30	2316.78
3	24.50 X 54.58	1337.21	1937.10	1599.30	2316.78
4	24.50 X 54.58	1337.21	1937.10	1599.30	2316.78
5	24.50 X 54.58	1337.21	1937.10	1599.30	2316.78
6	24.50 X 54.58	1337.21	1937.10	1599.30	2316.78
Total		8087.72	11716.00	9672.91	14012.34

Subplot area table for Dholera-345, FP-148

Subplot number	Dimensions (Mt)	Subplot area (Sqmt)	Permissible Ground coverage @ 50% (sqmt)	Permissible FSI as per GDCR	Permissible FSI @ 1.8(Sqmt)	Utilized FSI (sqmt)
1	26.00 X 54.58 = 308.02 Lees curve = 17.41	1401.67	700.84	1.80	2523.01	289.00
2	24.50 X 54.58	1337.21	668.61	1.20	1604.65	189.46
3	24.50 X 54.58	1337.21	668.61	1.20	1604.65	189.46
4	24.50 X 54.58	1337.21	668.61	1.20	1604.65	189.46
5	24.50 X 54.58	1337.21	668.61	1.20	1604.65	189.46
6	24.50 X 54.58	1337.21	668.61	1.20	1604.65	189.00
TOTAL		8087.72	4043.86	--	10546.27	1335.84

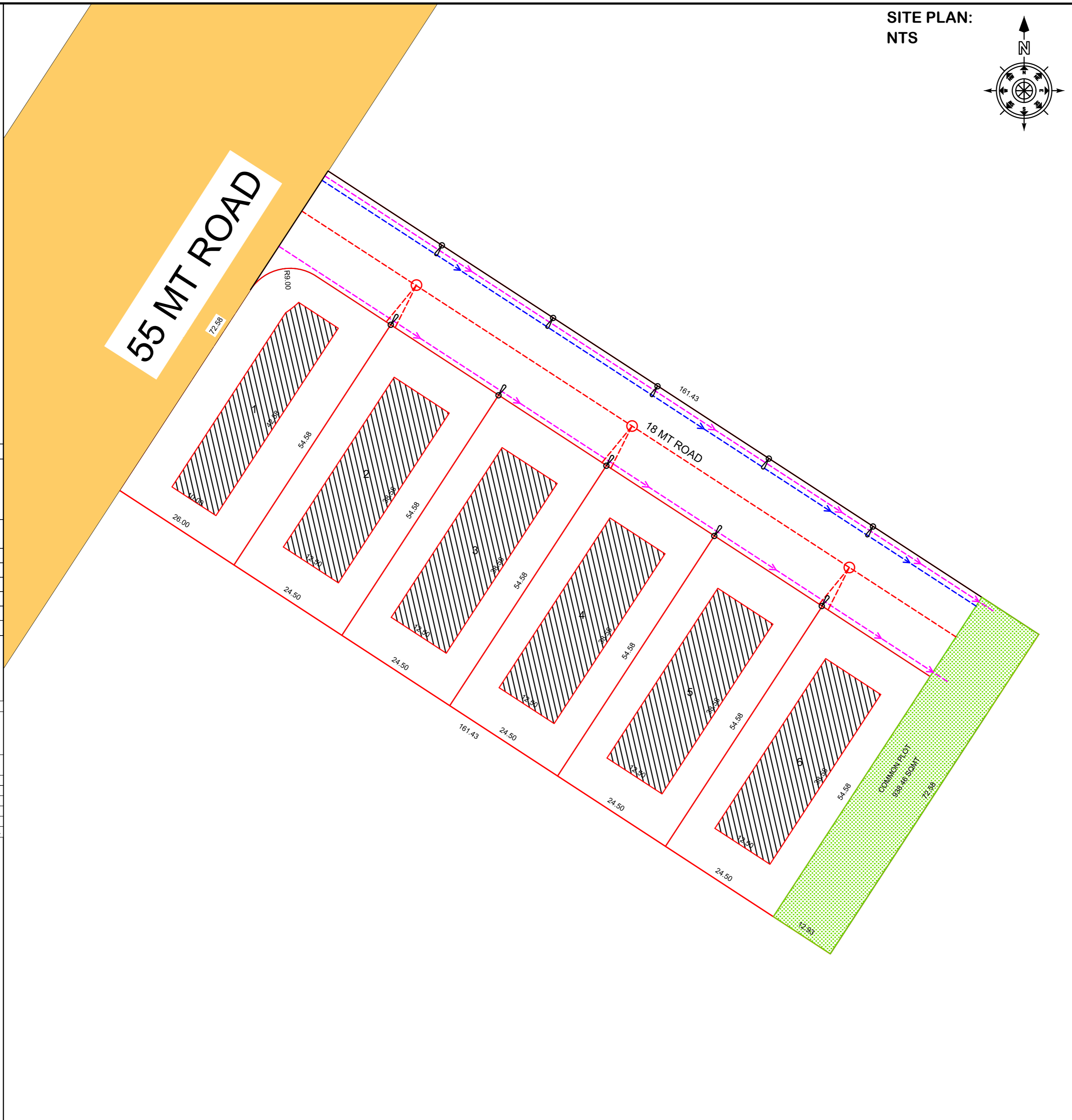

SITE PLAN:
NTS

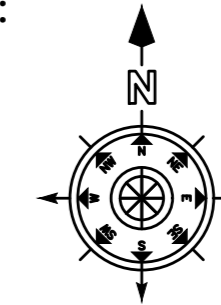

LAYOUT SHOWING PROPOSED OPEN SUBPLOT FOR SURVEY NUMBER 345, VILLAGE DHOLERA, TA. DHOLERA, DIST. AHMEDABAD TP SCHEME NO. 2B1

ZONE: INDUSTRIAL

AREA TABLE

DISCRPTION	AREA IN SQ.MT.
AREA OF SURVEY No. 345	11716.00
AREA OF OP No. 148	11716.00
AREA OF FP No. 148	11716.00
AREA OF INTERNAL ROAD	2689.82
AREA OF COMMON PLOT REQUIRED AS PER GDCR	937.28 (8%)
AREA OF COMMON PLOT PROVIDED	938.46
AREA OF SUB-PLOTS	8087.72

FSI TABLE

TOTAL AREA OF SUBPLOTS - 8087.72 SQMT
TOTAL PERMISSIBLE FSI = 10546.27 SQMT

CALCULATION FOR PERCOLATION WELL

1 PERCOLATION WELL / 4000 SQ.MT.
11716 / 4000 SQ.MT. = 2.93 PERCOLATION WELL REQUIRED
NUMBER OF PERCOLATION WELL PROVIDED = 3

CALCULATION FOR COMMON PLOT

COMMON PLOT : 12.93 X 72.58 = 938.46 SQMT

CALCULATION FOR TREE PLANTATION

TOTAL PLOT AREA = 11716.00 SQMT
TOTAL SUBPLOT AREA = 8087.72 SQMT
TOTAL TREE PLANTATION REQUIRED
2 Tree / 100 sqmt of builtup area
Total permissible FSI = 10546.27 sqmt
10546.27 / 100 = 105.46 X 2 (Say 210.92 Trees)
Proposed trees = 211

- N OP No. & Boundary
- N FP No. & Boundary
- N DP / TP Road
- N Proposed Internal Roads
- N Proposed Common Plots
- N Proposed Sub-Plots
- N Proposed drainage line
- N Proposed water supply line
- N Proposed storm water collection line
- N Proposed Light poles

SPECIFICATIONS

DRAINAGE SYSTEM: Under ground cement pipe at the centre of road
ROAD: Finished with good quality paver blocks
STORM WATER CHANNEL: RCC storm water channel on both sides of road with grill cover
STREET LIGHT: LED street lights with light poles on both sides of road
WATER SUPPLY: Potable water supply on one side of the road
ELECTRIC LINE: under ground electric line on both sides of road under street light poles
COMMON PLOT: garden and if needed electric sub station room

OWNERS

ARCHITECT

DHOLERA SPECIAL INVESTMENT
REGIONAL DEVELOPMENT AUTHORITY